

# 23 dBm Booster EDFA Module, C-band

The Optilab EDFA-B-C-M Booster EDFA module is an easy-to-use and cost-efficient solution for photonic subsystems, OEM integration, and fiber optic system integration.

EDFA-B-C-M 23 dBm Booster EDFA Module, C-band

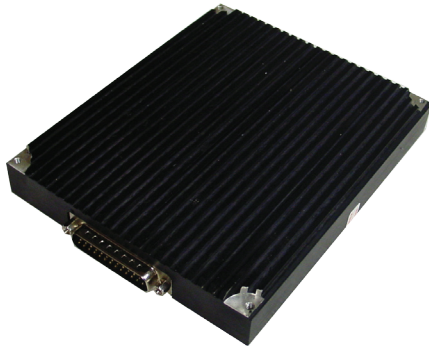

## Product Description

The Optilab EDFA-B-C-M Booster EDFA module is an easy-to-use and cost-efficient solution for photonic subsystems, OEM integration, and fiber optic system integration. Using dual stage design, this module features high optical gain, low noise, and up to 24 dBm output power level. Software control is standard via an RS-232 port for EDFA monitoring and pump current adjustments. Pump laser protection and alarms are equipped to ensure the reliability and safety of the device. The module requires only a  $\pm 5$  VDC power supply for operation which comes included with each EDFA-B-C-M as well as a standard with a three-year warranty.

## Features

- High output up to 24 dBm
- Low noise figure
- High reliability dual-pump laser
- RS-232 standard for remote control
- Wide wavelength operation range
- +5 V power supply
- 10+ years of operation life
- Adjustable current for each pump

## Applications

- OEM integration for
  - DWDM networks
  - HFC/CATV
  - RFoG/FTTH
- Photonic subsystems
- Fiber optic link amplification

## PRODUCT SPECIFICATIONS

### General Specifications

Operating Range	1528 nm to 1563 nm
Noise Figure (NF)	5.0 dB max. @ 0 dBm input
Optical Return Loss	50 dB min.
Input Optical Isolation	30 dB min.
Output Optical Isolation	30 dB min.
Polar. Mode Dispersion	0.1 ps max.
Polar. Dependent Gain	0.1 dB max.
Input Power Range	-10 dBm to +3 dBm
Output Power Stability	0.1 dB over 8 hours
Input/Output Fiber Type	Corning SMF-28

### EDFA-22B-C-M Specifications

Output Power Levels	+22 dBm min.
Optical Gain	22 dB typ. @ 0 dBm input

### EDFA-23B-C-M Specifications

Output Power Levels	+23 dBm min.
Optical Gain	23 dB typ. @ 0 dBm input

### EDFA-24B-C-M Specifications

Output Power Levels	+24 dBm min.
Optical Gain	24 dB typ. @ 0 dBm input

## Ordering Information

### EDFA-xxB-C-M

Output Power;  
22, +22 dBm output power  
xx  
23, +23 dBm output power  
24, +24 dBm output power



5110 N 44th St, Ste 200L, Phoenix AZ 85018

optilab.com 888-553-3888 602-343-8228 sales@optilab.com



To order this product online, visit our site at [oequest.com](http://oequest.com)

Product specifications and description are subject to change without notice.  
© 2010 Optilab, LLC.

## Mechanical Drawing

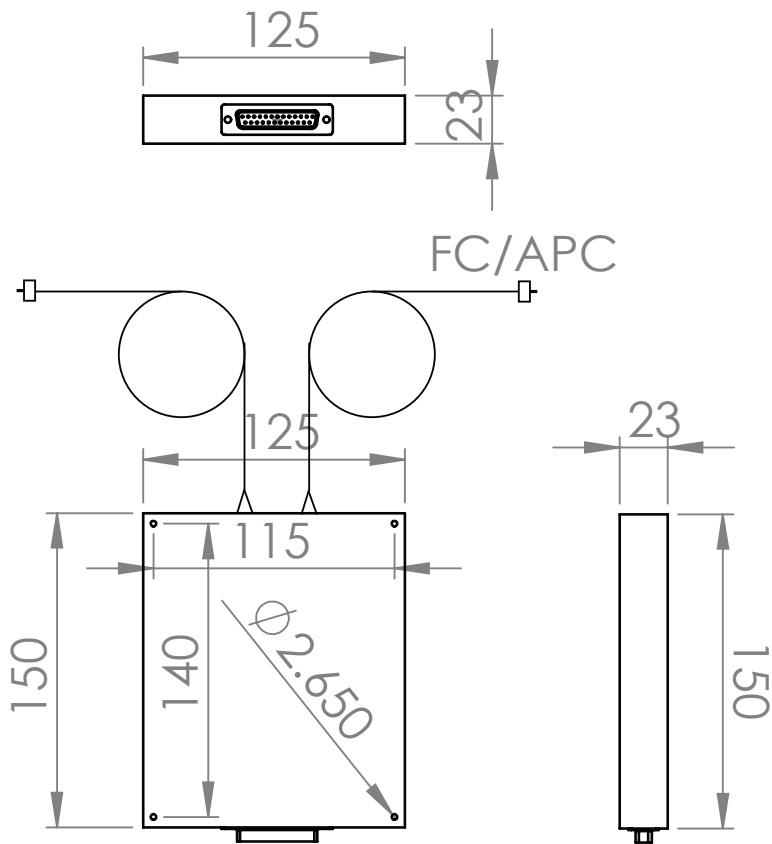

## 23 dBm Booster EDFA Module, C-band

### Mechanical Specifications

Operating Temperature	-10° to +70° C
Power Supply	+5 V DC, 5.0 A max.
Power Consumption	20 W max.
Fiber Type	SMF-28
Fiber Jacket	900 μm
Connector Type	FC/APC
Connector (Power & RS-232)	DB-25 Male
Display	LEDs for On/Off, Power
Remote Control	RS-232 for laser control, status monitoring
Dimensions	150 mm x 125 mm x 23 mm
Accessories Included	110 V - 240 V AC Adaptor for +5 V DC and cable

### PIN Out Diagram

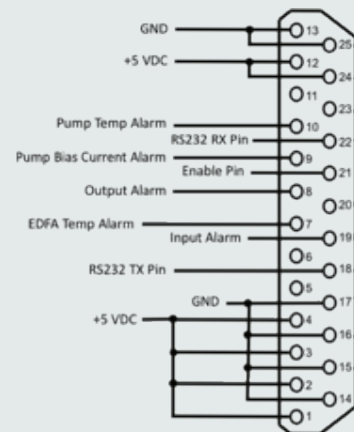

### DB-25 Connector

Pins 1, 2, 3, 4, 12, 24	+5 V DC
Pin 13, 14, 15, 16, 17, 25	Ground
Pin 7	EDFA Temperature Alarm
Pin 8	Output Alarm
Pin 9	Pump Bias Current Alarm
Pin 10	Pump Temperature Alarm
Pin 18	RS-232 Tx for Data
Pin 19	Input Alarm
Pin 21	Enable
Pin 22	RS-232 Rx for Data



**Optilab**

5110 N 44th St, Ste 200L, Phoenix AZ 85018

optilab.com 888-553-3888 602-343-8228 sales@optilab.com